

Technical Information	Date: 13.08.2020 Official: Eckl Department: BT-FIR/MKP1
------------------------------	---

Tech. Information No.	2314 / 2020
Subject:	MCP_ROW_Indoor

Short Description:	Installation note for correct installing MCP indoor devices.
---------------------------	--

Hardware <input checked="" type="checkbox"/>	<input checked="" type="checkbox"/> Device	<input type="checkbox"/> Module	<input type="checkbox"/> PCBA
Software <input type="checkbox"/>	<input type="checkbox"/> Application	<input type="checkbox"/> Driver / Extension	<input type="checkbox"/> Firmware

Affected Products (details)	CTN	SAP no.	Aff. version	New version
GLT/ROW manual call point	FMC-300RW-GSGBU(indoor)	F01U012724	n/a	n/a
GLT/ROW manual call point	FMC-300RW-GSGRD(indoor)	F01U012771	n/a	n/a
GLT/ROW manual call point	FMC-300RW-GSGYE(indoor)	F01U012778	n/a	n/a
LSN/ROW manual call point	FMC-420RW-GFGRD(indoor)	F01U012783	n/a	n/a
LSN/ROW manual call point	FMC-420RW-GSGBU(indoor)	F01U012707	n/a	n/a
LSN/ROW manual call point	FMC-420RW-GSGRD(indoor)	F01U012781	n/a	n/a
LSN/ROW manual call point	FMC-420RW-GSGYE(indoor)	F01U012787	n/a	n/a
LSN/ROW manual call point	FMC-420RW-GSRBU(indoor)	F01U012708	n/a	n/a
LSN/ROW manual call point	FMC-420RW-GSRYE(indoor)	F01U012788	n/a	n/a
LSN/ROW manual call point	FMC-420RW-GSRRD(indoor)	F01U012782	n/a	n/a
GLT/ROW manual call point	FMC-300RW-GSRBU(indoor)	F01U012770	n/a	n/a
GLT/ROW manual call point	FMC-300RW-GSRYE(indoor)	F01U012779	n/a	n/a
GLT/ROW manual call point	FMC-300RW-GSRRD(indoor)	F01U012777	n/a	n/a

Number of delivered devices	n/a
Period of delivery	from: n/a to: n/a
Affected serial numbers	from: to:

Priority Level	Criterion
I <input type="checkbox"/>	The change has to be made immediately (see dates below)
II <input type="checkbox"/>	The change has to be made during the next inspection.
III <input checked="" type="checkbox"/>	Change has to be made, if the error pattern recurs and with new installations.
None <input type="checkbox"/>	General Information (like new tool, new feature, new SW release)

Action Plan	
<input checked="" type="checkbox"/>	Inform customers
<input type="checkbox"/>	Arrange re-work of stock (CSO)
<input type="checkbox"/>	Arrange re-work of stock (customer)
<input type="checkbox"/>	Arrange re-work of installed products
<input type="checkbox"/>	See detailed actions on following pages

Start Date		Completion Date	
-------------------	--	------------------------	--

Print out of this template is not subject of the updating service. Only the version in the Intranet is always up to date.

New Features:

Please be careful when conducting the following step from the installation manual:

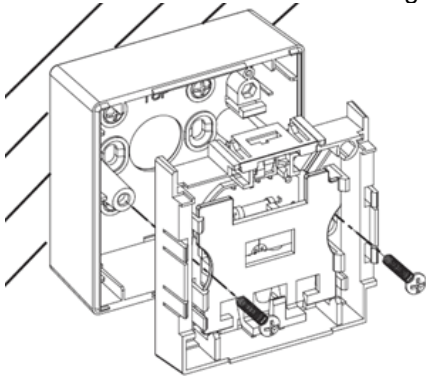

It is possible that the manual call point housing does not fit easily between the positioning ribs (Rib A and Rib B).

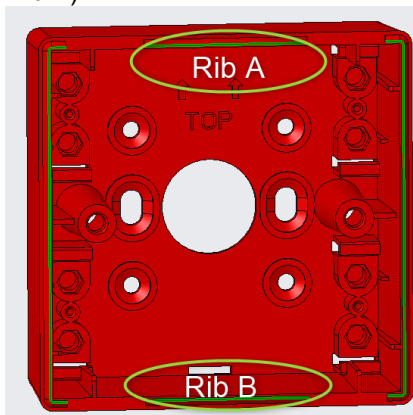

Please make sure that you place the MCP correctly between these ribs. Do not accept overlap like this:

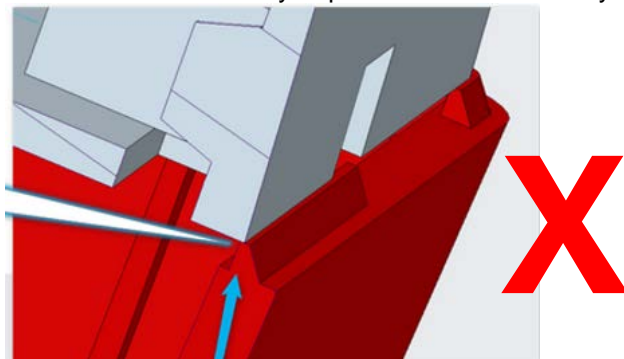

Correctly installed it should look like this:

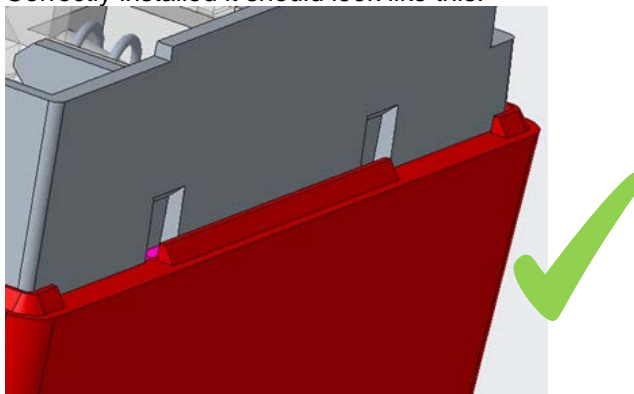

Installation Note for all manual call points (RW) indoor types:

Herewith we point out that a wrong installation of manual call points FMC 300RW and FMC 420RW indoor series could affect the IP class. To ensure that IP class is not affected due to wrong installation please be aware that the backside and the front side of manual call point housing fits perfectly together. Therefore it is recommended to check also the field during next periodical inspections.

1. How it shall look like:**2. How it don't shall look like:**

In case of wrong installation a cleft is visible as shown in the pictures above.

3. At which installation step you should take care:

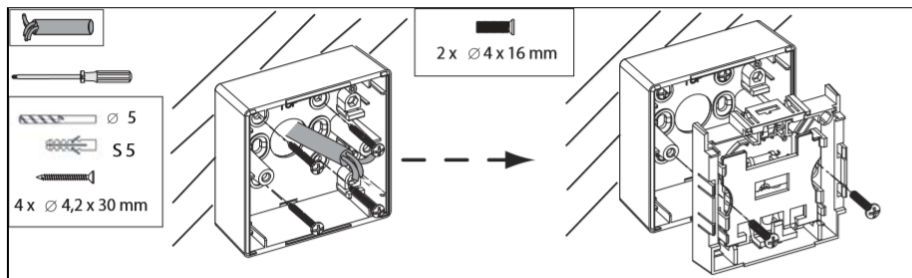

2

In the installation guide of the manual call points RW types you can find step 2 assembling, as shown above in that screenshot.

Required Components	Part no.

Attachment(s)

BU Manager	Thomas Knauel	Clerk in Charge:	Michael Heckl
-------------------	---------------	-------------------------	---------------

Distribution

Distribution BU FIR Fire Systems	<input checked="" type="checkbox"/>	Julian Tersteegen (BT-FIR/QMM), Claudia Majer (BT-FIR/QMM), Knauel Thomas (BT-FIR/MKP BT-FIR/MKT), Heckl Michael (BT-FIR/MKP3)
	<input checked="" type="checkbox"/>	Angstenberger Josef (BT-FIR/MKR-EU)
	<input checked="" type="checkbox"/>	Ong Kah Seong (BT-FIR/MKR-AP), Leonard Hew (BT-FIR/MKR-AP)
	<input checked="" type="checkbox"/>	Paredes Ivan (BT/MKR-LA), Miers Christopher (BT/FIR-MKT)
	<input checked="" type="checkbox"/>	Haug Stefan (BT-FIR/MKR-EU BT-FIR/MKA-EU)
	<input type="checkbox"/>	

Distribution BU SC Intrusion Systems	<input type="checkbox"/> Petricoin Dennis (BT-SC/PAS2 BT-SC/PAS2-MKP), Dobson Roxanne (BT-SC/QMM2), Hupka Peter (BT-SC/PAS2-MKP5), Weissert Thorsten (BT-SC/PAS2-MKP5) <input type="checkbox"/> Kugler Gerhard (BT-SC/MKR6-EU), Berberian Alexandra (BT-SC/MKR-SEF), Shah Dhaval (BT-FIR/MKR-SEM), Gomez Arevalo Olga (BT/SEI-SCM), Malek Michal (BT-SC/MKR-SEP), van den Berg Quintin (BT-SC/MKR-SEZ), Kiselev Grigory (BT-FIR/MKR-SEO), Sonmez Onur (BT-FIR/MKR-SET), Cojocaru Laurentiu (BT-SC/MKR-SEA BT/SEA-SBD2), Riboli Stefano (BT-SC/MKR-SES), El Makhfi Otmane (BT-SC/MKR-SAN), Reuvers Willfried (BT-SC/MKR-SEB), Kuehlewind Uwe (BT-SC/MKR-SEC), Pillai Kiran (BT-SC/MKR-SEU), Karlsson Anders (BT-SC/MKR-SEN) <input type="checkbox"/> Cabral Paula (BT-SC/MKR-LA), Garms Paul (BT-SC/MKR2-NA) <input type="checkbox"/> Premo Mike (BT-SC/PAS2-ENG1), Meichelbeck Markus (BT-SC/PAS2-ENG5) <input type="checkbox"/> Schmidt Michaela (BT/MKW1) <input type="checkbox"/> Klein Alexander (BT/SC-MKI) <input type="checkbox"/>
Other parties affected	<input checked="" type="checkbox"/> Schrimpf Felix (BT-ASA/MKP BT-ASA/MKC) <input checked="" type="checkbox"/> Proyer Konrad (BT-ASA/SRA-EU BT-ASA/SRA2-EU), Dias Andre (BT-ASA/SRA-LA), Wilson Jim (BT-ASA/SRA-NA), Tan Woo Khiang (BT-ASA/SRA-AP) <input checked="" type="checkbox"/> Gill Manjit (BT-ASA/STS-UK) <input checked="" type="checkbox"/> Teleservice Support (SO/OMM1.3-MB) <input checked="" type="checkbox"/> Heiko Schwichtenberg (BT-IE/PRM-SF) <input checked="" type="checkbox"/> Adelmann Petra (BT-IE/EAP3) <input type="checkbox"/>